

Topographical Survey at Cahirdown  
Wood, Listowel, Co. Kerry.  
Olive Pierse

Client: JM Ltd  
Scale: 1:500 on A1  
Date: May 2017  
Dwn By: JM  
Dwg No: 17-05-273  
Ckd By: JM

JM Ltd  
Mill Road,  
Kanturk,  
Co. Cork.  
(087) 9524406 (029)20179  
Email:jmsurveyskanturk@gmail.com Web:www.jmsurveys.ie

- (1) Existing entrance to Pierse family homes, farm from N69
- (2) Existing unused farm entrance to Cahirdown Wood
- (3) Entrance granted by Kerry County Council in 2000 (Now closed off by JR)
- (4) Entrance refused twice by Kerry County Council to Mr. Pierse
- (5) New entrance to Cahirdown Wood (2003)
- (A) (B) Gates in question referred to by Bord Pleanala
- (E) Existing connecting gate to field from Cahirdown Wood field (No road to it)

Line Types	Notes:
--- Kerb Bottom Line	LS - Light Standard
- - - Edge of Vegetation	
— Fence Line	
— Building Line	
— Edge of Concrete	
— Wall Line	
— Bank Bottom Line	
— Bank Top Line	
— Road Line	
— Electricity Pole Line	
— Telegraph Pole Line	
— Track Line	

Survey Co Ordinates are in Irish National Grid (ITM)  
All levels shown are in metres and relate to malin head datum

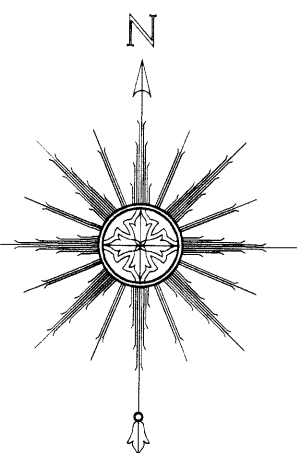

*applicant*  
306614-20

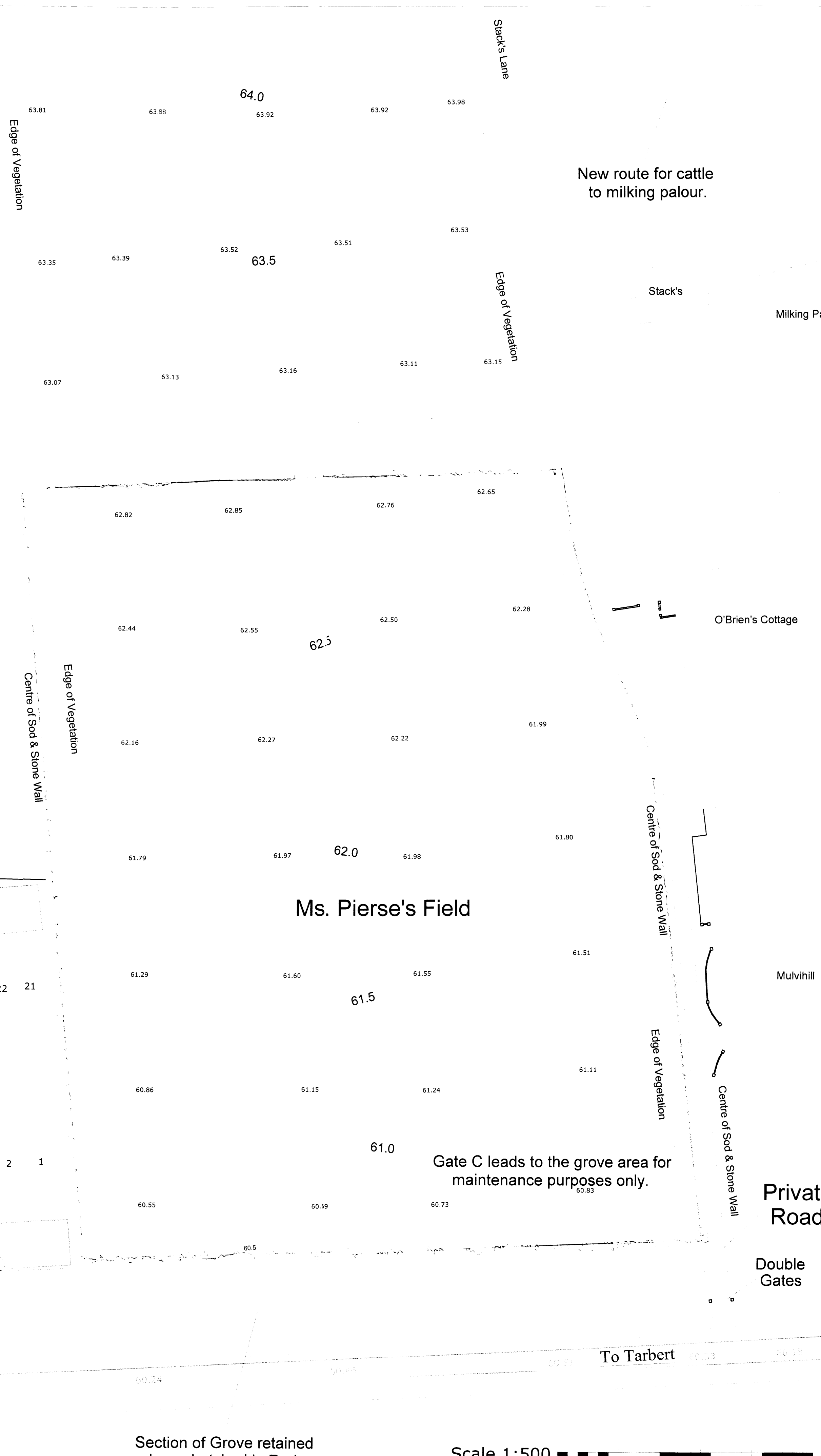

Section of Grove retained  
shown hatched in Red

Scale 1:500  
0 10 20 25 40 50